

Top Drive Circulating Tool

Start
June 10th 2003

Oil Company seeks assistance with a design (rough sketch)

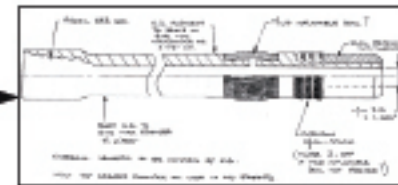

June 24th 2003

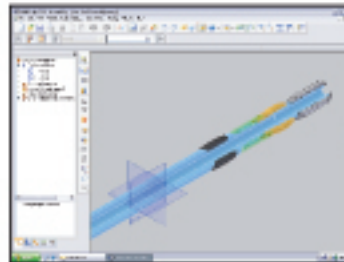

PDC designs and models Top Drive Circulating Tool - completing main drawings and design/manufacture tooling for the rubber moulders

July 3rd 2003

Machining of prototype parts and test equipment. Pressure test conducted in house with moulded seals



The final product is tested and delivered to the rig for use.

